

## World's first sound bar with virtual 3D surround

The ATS-2070 brings immersive home theatre sound, featuring DTS Virtual:X technology that creates virtual 3D surround sound and richly dynamic bass reproduction only possible with a subwoofer-equipped two-unit type. This advanced Sound Bar features comprehensive functionality, including a Clear Voice function, *Bluetooth*<sup>®</sup> capability, smartphone app control, HDMI<sup>®</sup> terminals, and more.



### High Sound Quality

- Virtual 3D surround sound by DTS Virtual:X\*  
\*Available via future firmware update.
- Two-unit sound bar system with wireless subwoofer
- Clear Voice function
- Five surround modes

### Beautiful Installation and Simple Connection

- Slim, understated design to fit any system
- Wireless slim type subwoofer for flexible placement
- Touch-type operating buttons
- Wireless music streaming via *Bluetooth*
- HDMI (1 in / 1 out) terminals with HDR Video, 4K/60p (4:4:4) pass-through and HDCP2.2

### Easy to Use

- Home Theater CONTROLLER app for easy control
- HDMI with CEC and ARC (Audio Return Channel)



### Main Specifications

|                           |  |
|---------------------------|--|
| Output Power              | 200 W total power: 100 W + 100W subwoofer  |
| System Frequency Response | 40 Hz–23 kHz   |
| <b>Centre unit</b>        |  |
| Type                      | Acoustic Suspension  |
| Drivers                   | 4.6 cm (1-3/4") woofer x 4, 2.5 cm (1") tweeter x 2<br>(Input) HDMI:1, Digital (Optical):1,  |
| Terminals                 | Analogue (3.5mm stereo mini):1,<br>USB:1* * Only for firmware update.<br>(Output) HDMI:1   |
| Dimensions (W x H x D)    | 930 x 60 x 108 mm<br>36-5/8" x 2-3/8" x 4-1/4"   |
| Weight                    | 2.7 kg; 6.0 lbs.   |
| Power Consumption         | 30 W   |
| Standby Power Consumption | Less than 0.4 W (HDMI control off, Bluetooth standby off)<br>Less than 0.9 W (HDMI control on, Bluetooth standby off)<br>Less than 0.5 W (HDMI Control off, Bluetooth standby on)<br>Less than 0.9 W (HDMI Control on, Bluetooth standby on) |
| <i>Bluetooth</i>          | (Version) Ver.4.1, (Profile) A2DP, SPP<br>(Audio codec) SBC, MPEG AAC* * Receiving only.   |
| <b>Wireless Subwoofer</b> |  |
| Type                      | Bass-reflex  |
| Driver                    | 16 cm (6-1/4") cone woofer   |
| Dimensions (W x H x D)    | 180 x 437 x 401 mm<br>7-1/8" x 17-1/4" x 15-3/4"   |
| Weight                    | 7.9 kg; 17.4 lbs.  |
| Power Consumption         | 19 W   |
| Supplied items            | Owner's manual, Remote control, Power cord x 2,<br>Optical digital audio cable (1.5 m [4.9 ft]),<br>Mounting template  |

# Front Surround System ATS-2070

NEW PRODUCT BULLETIN

## High Sound Quality

### Virtual 3D Surround Sound by DTS Virtual:X

The ATS-2070 supports DTS Virtual:X technology for reproducing virtual 3D surround sound. This adds a virtual overhead channel, providing exceptionally realistic sound filled with spacious stereo presence that immerses you in the action, enhancing the emotion and excitement of the TV images. Moreover, there's a special "Up-mix" function which creates a virtual height channel – even for sources that are not virtual 3D surround compatible – to enhance the spacious multi-dimensional presence with the sensation of height.

\*Available via future firmware update.



### Dynamic, Clear Sound

The ATS-2070 centre unit includes four 46 mm (1-3/4") woofer units and two 25 mm (1") tweeter units. It utilises newly designed circular speaker units and its cabinet capacity is optimised to improve sound quality – delivering dynamic, clear sound for an immersive listening experience that brings your TV/video content to life.

**4** Woofers **2** Tweeters



### Wireless Slim Type Subwoofer for Trilling Bass

The ATS-2070 system includes a slim type wireless subwoofer that features a 16 cm (6-1/4") woofer unit on the side of the cabinet, and delivers high-powered output of 100 watts for bass reproduction that is rich, dynamic and expansive. It is compatible with wireless connections and comes in a slim, compact cabinet for exceptionally flexible installation.



### Clear Voice Function

Clear Voice raises the level of dialogue and narrations while maintaining overall sound quality. Movies and TV shows, sports commentary and news broadcasts are more clearly audible.



### Five Surround Modes

The ATS-2070 offers a choice of five surround programmes: Music, TV Program, Movie, Sports and Game. Choose the one to match what you're watching and enjoy the best possible surround sound quality.

## Beautiful Installation and Simple Connection

### Attractive Presence with Softly Rounded Edges



Low-profile design



Touch-type operating buttons



Wall mountable



L-shape design with fabric and plastic combination

### Wireless Music Streaming via Bluetooth

Listen to any and all music from your smartphone via the wireless Bluetooth connection. You can play music from music apps, radio apps, or YouTube™-type video hosting services, and more. Furthermore, for compressed sound sources, the Music Enhancer function restores frequency response lost during digital compression, so your music sounds the way it should. It is optimised for any compressed content, for vivid, lively sound quality.



### HDMI Terminal with 4K Ultra HD, ARC Support

The ATS-2070 is equipped with HDMI input/output terminals, and supports 4K/60p video signal pass-through. In addition to supporting HDR (High Dynamic Range), the standard for the 4K Ultra HD Blu-ray format, the units are also compliant with the latest HDCP 2.2 digital copy protection. It also includes an Audio Return Channel function, enabling data to be sent and received via the same HDMI cable, so you can hear the sound from the TV via a single HDMI cable, with no need for an extra optical cable.

## Easy to Use

### Home Theater Controller App

The ATS-2070 is compatible with a free controller app for iOS and Android. The intuitive and easy-to-see operating screen uses icons that let you easily perform a variety of operations. You can also select five surround modes: Movie, Sports, Game, Music, or TV programme.

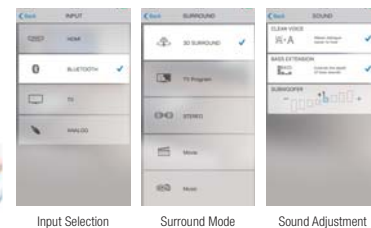

### HDMI CEC

Another benefit of HDMI is the availability of CEC functionality. When the unit is connected to a CEC compatible TV, it will turn on and off together with the TV, and you can use the TV remote to control the volume.

• "Made for iPod," "Made for iPhone," and "Made for iPad" mean that an electronic accessory has been designed to connect specifically to iPod, iPhone, or iPad, respectively, and has been certified by the developer to meet Apple performance standards. Apple is not responsible for the operation of this device or its compliance with safety and regulatory standards. Please note that the use of this accessory with iPod, iPhone, or iPad may affect wireless performance. AirPlay, iPad, iPhone, iPod, iPod nano, and iPod touch are trademarks of Apple Inc., registered in the U.S. and other countries. • Android is a trademark of Google Inc. • The Bluetooth® word mark and logos are registered trademarks owned by Bluetooth SIG, Inc. and any use of such marks by Yamaha Corporation is under licence. Other trademarks and trade names are those of their respective owners. • Manufactured under license from Dolby Laboratories. Dolby, Dolby Audio, Pro Logic, and the double-D symbol are trademarks of Dolby Laboratories. • For DTS patents, see <http://patents.dts.com>. Manufactured under license from DTS Licensing Limited. DTS, the Symbol, & DTS and the Symbol together are registered trademarks, and DTS Digital Surround is a trademark of DTS, Inc. © DTS, Inc. All Rights Reserved.