

The easy way to the best TV sound

Enjoy powerful, high-quality sound from your TV—easily and simply! The YAS-107 is compatible with DTS Virtual:X, ensuring 3D surround excitement, with just a single unit. Featuring comprehensive functionality, including *Bluetooth*[®], smartphone app control, HDMI[®] terminals, and more, the YAS-107 expands your TV and music entertainment pleasure.



High Sound Quality

- Dynamic and clear TV sound from just a single unit
- Clear Voice function makes dialogue and narration easy to hear
- Virtual 3D surround sound by DTS Virtual:X*
*Available via future firmware update.
- Built-in subwoofers, with 3-way 6-speaker configuration
- Five surround modes
- Adjustable bass
- Subwoofer terminal

Beautiful Installation and Simple Connection

- Ultra-slim, beautifully-simple design
- Slim body, just 53 mm (2-1/8") in height, never blocks view of the TV screen
- Touch-type operating buttons
- Wireless music streaming via *Bluetooth*
- HDMI (1 in / 1 out) terminals with HDR Video, 4K/60p (4:4:4) pass-through and HDCP2.2

Easy to Use

- HOME THEATER CONTROLLER app for easy control
- HDMI with CEC and ARC (Audio Return Channel)



Main Specifications

Maximum Output Power	120 W total power (30 W x2, 60 W built-in subwoofer)
System Frequency Response	60 Hz-23 kHz
Drivers	Dual 5.5 cm (2-1/8") woofers, Dual 2.5 cm (1") tweeter, Dual 7.5 cm (3") built-in subwoofers
Terminals	(Input) HDMI:1, Digital (Optical):1, Analogue (3.5mm stereo mini):1, USB:1* * Only for firmware update. (Output) HDMI:1, Subwoofer:1
Dimensions (W x H x D)	890 x 53 x 131 mm; 35" x 2-1/8" x 5-1/8" (In front of TV placing) 890 x 131 x 62 mm; 35" x 5-1/8" x 2-1/2" (Wall mount setting with spacer)
Weight	3.4 kg; 7.5 lbs.
Power Consumption	27 W
Standby Power Consumption	Less than 0.4 W (HDMI control off, Bluetooth standby off) Less than 0.8 W (HDMI control on, Bluetooth standby off) Less than 0.5 W (HDMI Control off, Bluetooth standby on) Less than 0.8 W (HDMI Control on, Bluetooth standby on)
Bluetooth	(Version) Ver.4.1, (Profile) A2DP, SPP (Audio codec) SBC, MPEG AAC* * Receiving only.
Supplied items	Owner's manual, Remote control, Power cord, Optical digital audio cable (1.5 m [4.9 ft]), Spacer, Mounting template

Front Surround System YAS-107

High Sound Quality

Dynamic, Clear Sound — from a Single Unit

With its advanced sound features and functionality, the YAS-107 can be added to any current TV setup, and fill the room with astonishingly dynamic, clear and powerful sound. In addition, a Clear Voice function puts narration and dialogue upfront, yet maintains overall sound quality — making movies, TV shows, sports commentary and news casts all instantly more clear and audible.



Virtual 3D Surround Sound by DTS Virtual:X

The YAS-107 supports DTS Virtual:X technology for reproducing virtual 3D surround sound. This adds a virtual overhead channel, providing exceptionally realistic sound filled with spacious stereo presence that immerses you in the action, enhancing the emotion and excitement of the TV images. Moreover, there's a special "Up-mix" function which creates a virtual height channel — even for sources that are not virtual 3D surround compatible — to enhance the spacious multi-dimensional presence with the sensation of height.

*Available via future firmware update.

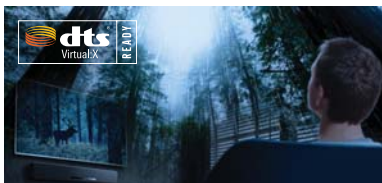

Built-in Subwoofers, with 3-way 6-speaker Configuration

The YAS-107 features dual, built-in 75 mm (3") subwoofers plus a bass reflex port. It is equipped with newly designed two 55 mm (2-1/8") woofer units and 25 mm (1") tweeter units, and its cabinet capacity is optimised for sound quality. It also utilises a dual-amp drive that drives the subwoofer, woofer/tweeter with separate amps, delivering exceptionally wide-range sound, richly balanced in the mid and low ranges.



Five Surround Modes

The YAS-107 offers a choice of five surround programmes: Music, TV Program, Movie, Sports and Game. Choose the one to match what you're watching and enjoy the best possible surround sound quality.

Adjustable Bass

Since powerful and deep low frequencies more easily pass through walls — and can disturb others — this convenient feature was designed to allow independent control over the volume of the bass, right on the remote or the special app.

Subwoofer Terminal

If you have a subwoofer, you can connect it by cable to the YAS-107, and get more impact, power and enjoyment from movies, concert videos — and all your music that benefits from big bass.

Beautiful Installation and Simple Connection

Ultra-slim, Beautifully-Simple Design



Low-profile design never obstructs view of TV



Touch-type operating buttons

Wireless Music Streaming via Bluetooth

Listen to any and all music from your smartphone via the wireless Bluetooth connection. You can play music from music apps, radio apps, or YouTube™-type video hosting services, and more. Furthermore, for compressed sound sources, the Music Enhancer function restores frequency response lost during digital compression, so your music sounds the way it should. It is optimised for any compressed content, for vivid, lively sound quality.



HDMI Terminal with 4K Ultra HD, ARC Support

The YAS-107 is equipped with HDMI input/output terminals, and supports 4K/60p video signal pass-through. In addition to supporting HDR (High Dynamic Range), the standard for the 4K Ultra HD Blu-ray format, the units are also compliant with the latest HDCP 2.2 digital copy protection. It also includes an Audio Return Channel function, enabling data to be sent and received via the same HDMI cable, so you can hear the sound from the TV via a single HDMI cable, with no need for an extra optical cable.

Easy to Use

HOME THEATER CONTROLLER App

The YAS-107 is compatible with a free controller app for iOS and Android. The intuitive and easy-to-see operating screen uses icons that let you easily perform a variety of operations. You can also select five surround modes: Movie, Sports, Game, Music, or TV programme.

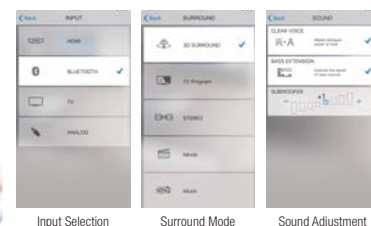

Input Selection

Surround Mode

Sound Adjustment

HDMI CEC

Another benefit of HDMI is the availability of CEC functionality. When the unit is connected to a CEC compatible TV, it will turn on and off together with the TV, and you can use the TV remote to control the volume.

• "Made for iPod," "Made for iPhone," and "Made for iPad" mean that an electronic accessory has been designed to connect specifically to iPod, iPhone, or iPad, respectively, and has been certified by the developer to meet Apple performance standards. Apple is not responsible for the operation of this device or its compliance with safety and regulatory standards. Please note that the use of this accessory with iPod, iPhone, or iPad may affect wireless performance. AirPlay, iPad, iPhone, iPod, iPod nano, and iPod touch are trademarks of Apple Inc., registered in the U.S. and other countries. • Android is a trademark of Google Inc. • The Bluetooth® word mark and logos are registered trademarks owned by Bluetooth SIG, Inc. and any use of such marks by Yamaha Corporation is under licence. Other trademarks and trade names are those of their respective owners. • Manufactured under license from Dolby Laboratories. Dolby, Dolby Audio, Pro Logic, and the double-D symbol are trademarks of Dolby Laboratories. • For DTS patents, see <http://patents.dts.com>. Manufactured under license from DTS Licensing Limited. DTS, the Symbol, & DTS the Symbol together are registered trademarks, and DTS Digital Surround is a trademark of DTS, Inc. © DTS, Inc. All Rights Reserved.